

COLTELLI REVERSIBILI STANDARD

Reversible knives

Wendeschneidplatten

Cuchillas reversibles

Сменные твердосплавные ножи

HW 45°

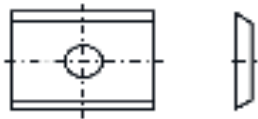
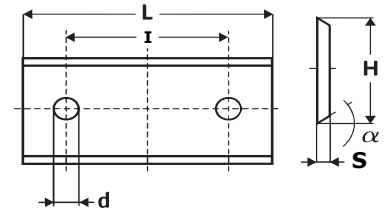

L	H	S	I				
mm	mm	mm	mm	F.01-4.T	SM.01-4.HMT	M.30-2.DT	F.10/40-3.DT
7.5	12.0	1.5					06.80.751215
9.6	12.0	1.5					06.80.961215
15.0	12.0	1.5					06.80.151215
20.0	12.0	1.5					06.80.201215
25.0	12.0	1.5					06.80.251215



L	H	S	I				
mm	mm	mm	mm	F.01-4.T	SM.01-4.HMT	M.30-2.DT	F.10/40-3.DT
25.0	12.0	1.5	14				06.90.251215
30.0	12.0	1.5	14				06.90.301215
40.0	12.0	1.5	26				06.90.401215
50.0	12.0	1.5	26				06.90.501215
60.0	12.0	1.5	26				06.90.601215
25.0	12.0	1.5					06.80.251215

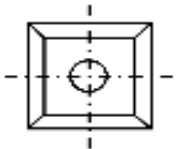

L	H	S	I				
mm	mm	mm	mm	F.01-4.T	SM.01-4.HMT	M.30-2.DT	F.10/40-3.DT
12.0	12.0	1.5					06.90.121215