

COLTELLI REVERSIBILI - Caratteristiche del grano e applicazioni

Reversible knives - grain size definition and applications

Wendeschneidplatten - Korngrößendefinition und Anwendungen Aplicaciones

Cuchillas reversibles - tamaño del grano y aplicaciones

Сменные ножи - характеристики зерна и область применения

Grado ILMA	Dimesioni del grano	HRC	Tenacità	Resistenza flessionale
<i>ILMA Grade</i>	<i>Grain size</i>		<i>Thoughtness</i>	<i>Bending Strenght</i>
SM.01-4.HMT	Micro 0,7-1,0 µm	84	*	*
F.01-4.T	Fine 1,0-1,4 µm	81	**	*
M.30-2.DT	Medium/Fine 1,4-2,5 µm	78	***	**
F.10/40-3.DT	Micro 0,7-1,0 µm	79	**	***

Grado ILMA	Codice	Legno tenero	Legno duro	Truciolare	MDF	HDF	Plastica
<i>ILMA Grade</i>	<i>Code</i>	<i>Softwood</i>	<i>Hardwood</i>	<i>Chipboard</i>			<i>Plastic</i>
SM.01-4.HMT	20			*	***	**	***
F.01-4.T	40	**	**	**	**	*	**
M.30-2.DT	80	**	**	**			
F.10/40-3.DT	90	**	**	**			

* Buono - Good - Gute Qualität - Bueno - Хорошего качества

** Molto buono - Very good - Sehr gute Qualität - Muy bueno - Очень хорошего качества

*** Ottimo - Excellent - Ausgezeichnete Qualität - Excelente - Отличного качества

COLTELLI REVERSIBILI STANDARD

Reversible knives

Wendeschneidplatten

Cuchillas reversibles

Сменные твердосплавные ножи стандарт

HW 35° Z=2

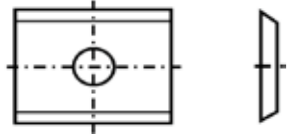
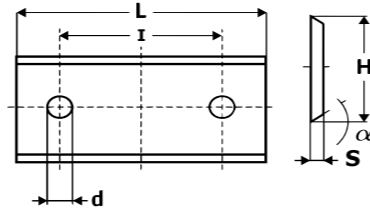

L	H	S	I	F.01-4.T	SM.01-4.HMT	M.30-2.DT	F.10/40.3.DT
7.5	12.0	1.5		01.40.751215			01.90.751215
8.6	12.0	1.5		01.40.861215			
9.0	12.0	1.5		01.40.901215			
9.6	12.0	1.5		01.40.961215			01.90.961215
10.0	12.0	1.5		01.40.101215			
10.5	12.0	1.5		01.40.1051215			
11.0	12.0	1.5		01.40.111215			
11.6	12.0	1.5		01.40.1161215			
13.0	12.0	1.5		01.40.131215			
13.6	12.0	1.5		01.40.1361215			
14.6	12.0	1.5		01.40.1461215			
15.0	12.0	1.5		01.40.151215	01.20.151215		01.90.151215
15.7	12.0	1.5		01.40.1571215			
16.0	12.0	1.5		01.40.161215			
17.0	12.0	1.5		01.40.171215			
18.0	12.0	1.5		01.40.181215			
19.0	12.0	1.5		01.40.191215			
20.0	12.0	1.5		01.40.201215	01.20.201215		01.90.201215
25.0	12.0	1.5		01.40.251215			01.90.251215

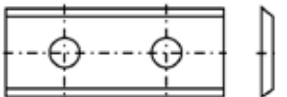

L	H	S	I	F.01-4.T	SM.01-4.HMT	F.10/40.3.DT
25.0	12.0	1.5	14.0	01.40.251215.2F		01.90.251215
30.0	12.0	1.5	14.0	01.40.301215	01.20.301215	01.90.301215
35.0	12.0	1.5	26.0	01.40.351215		
40.0	12.0	1.5	26.0	01.40.401215	01.20.401215	01.90.401215
50.0	12.0	1.5	26.0	01.40.501215	01.20.501215	01.90.501215
60.0	12.0	1.5	26.0	01.40.601215	01.20.601215	01.90.601215



L	H	S	I	M.30-2.DT	F.10/40.3.DT
80.0	13.0	2.2	60.0	01.80.801322	01.90.801322
100.0	13.0	2.2	60.0	01.80.1001322	01.90.1001322
120.0	13.0	2.2	60.0	01.80.1201322	01.90.1201322

COLTELLI REVERSIBILI STANDARD PER TESTE PIALLA

Reversible knives for planer heads

Wendeschneidplatten Für Hobelköpfe

Cuchillas reversibles para portacuchillas de cepillo

Сменные ножи стандарт для строгальных головок

HW Z=2

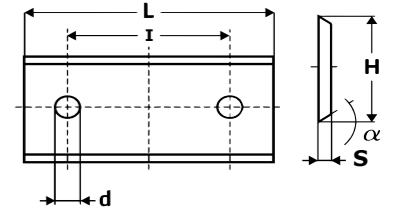

L	H	S	alpha	F.01-4.T	SM.01-4.HMT	M.30-2.DT	F.10/40-3.DT
20.0	12.0	1.5	35°				02.90.201215
20.0	12.0	1.5	45°				02.90.201215/45
24.0	12.0	1.5	40°	02.40.241215/40			02.90.241215/40
24.7	12.0	1.5	35°	02.40.2471215			02.50.2471215

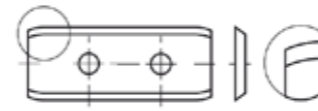

L	H	S	alpha	F.01-4.T	SM.01-4.HMT	M.30-2.DT	F.10/40-3.DT
30.0	12.0	1.5	35°	02.40.301215			02.90.301215
50.0	12.0	1.5	35°				02.90.501215

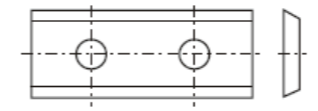

L	H	S	alpha	F.01-4.T	SM.01-4.HMT	M.30-2.DT	F.10/40-3.DT
30.0	12.0	2.5	35°	02.40.301225			

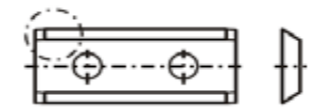

L	H	S	alpha	F.01-4.T	SM.01-4.HMT	M.30-2.DT	F.10/40-3.DT
30.0	12.0	2.5	35°			02.80.301225	

COLTELLI REVERSIBILI STANDARD

Reversible knives

Wendeschneidplatten

Cuchillas reversibles

Сменные твердосплавные ножи

HW 45°

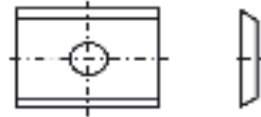
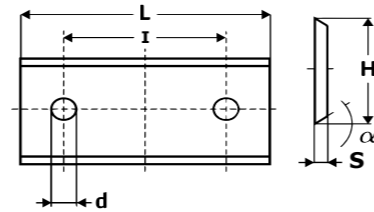

L	H	S	I	F.01-4.T	SM.01-4.HMT	M.30-2.DT	F.10/40-3.DT
mm	mm	mm	mm				
7.5	12.0	1.5					06.90.751215
9.6	12.0	1.5					06.90.961215
15.0	12.0	1.5					06.90.151215
20.0	12.0	1.5					06.90.201215
25.0	12.0	1.5					06.90.251215

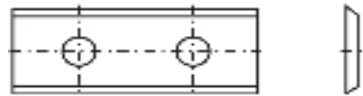

L	H	S	I	F.01-4.T	SM.01-4.HMT	M.30-2.DT	F.10/40-3.DT
mm	mm	mm	mm				
25.0	12.0	1.5	14				06.90.251215
30.0	12.0	1.5	14				06.90.301215
40.0	12.0	1.5	26				06.90.401215
50.0	12.0	1.5	26				06.90.501215
60.0	12.0	1.5	26				06.90.601215
25.0	12.0	1.5					06.90.251215

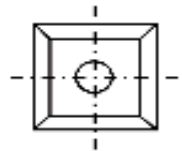

L	H	S	I	F.01-4.T	SM.01-4.HMT	M.30-2.DT	F.10/40-3.DT
mm	mm	mm	mm				
12.0	12.0	1.5					06.90.121215

COLTELLI REVERSIBILI

Reversible knives

Wendeschneidplatten

Cuchillas reversibles

Сменные твердосплавные ножи

HW Z=4

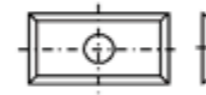
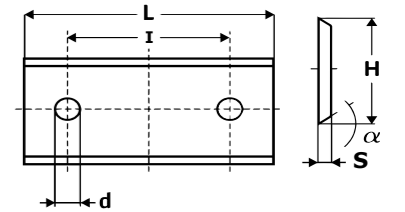

L	H	S	I	F.01-4.T	SM.01-4.HMT	M.30-2.DT	F.10/40-3.DT
mm	mm	mm	mm				
19.5	7.0	1.5		03.04.195715			
19.5	7.5	1.5		03.04.1957515			
19.5	8.0	1.5		03.04.195815			
19.5	9.0	1.5		03.04.195915			
19.5	10.0	1.5		03.04.1951015			
19.5	11.0	1.5		03.04.1951115			
19.5	12.0	1.5		03.04.1951215	03.20.1951215		

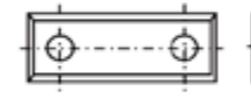

L	H	S	I	F.01-4.T	SM.01-4.HMT	M.30-2.DT	F.10/40-3.DT
mm	mm	mm	mm				
29.5	7.0	1.5	14.0	03.04.295715			
29.5	7.5	1.5	14.0	03.04.2957515			
29.5	8.0	1.5	14.0	03.04.295815			
29.5	9.0	1.5	14.0	03.04.295915	03.20.295915		
29.5	10.0	1.5	14.0	03.04.2951015			
29.5	11.0	1.5	14.0	03.04.2951115			
29.5	12.0	1.5	14.0	03.04.2951215	03.20.2951215		03.90.4951215

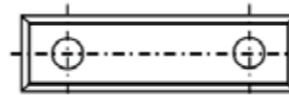

L	H	S	I	F.01-4.T	SM.01-4.HMT	M.30-2.DT	F.10/40-3.DT
mm	mm	mm	mm				
39.5	9.0	1.5	26.0	03.04.395915	03.20.395915		03.90.395915
39.5	12.0	1.5	26.0	03.04.3951215	03.20.3951215		03.90.3951215

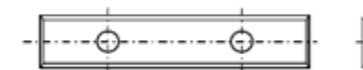

L	H	S	I	F.01-4.T	SM.01-4.HMT	M.30-2.DT	F.10/40-3.DT
mm	mm	mm	mm				
49.5	8.0	1.5	26.0	03.04.495815			
49.5	9.0	1.5	26.0	03.04.495915	03.20.495915		
49.5	10.0	1.5	26.0	03.04.4951015			
49.5	12.0	1.5	26.0	03.04.4951215	03.20.4951215		03.90.4951215
59.5	12.0	1.5	26.0	03.04.5951215			



L	H	S	I	F.01-4.T	SM.01-4.HMT	M.30-2.DT	F.10/40-3.DT
mm	mm	mm	mm				
50.0	9.0	1.5	37.0	03.04.50915			
50.0	12.0	1.7	37.0	03.04.501217	03.20.501217		03.90.501217

COLTELLI REVERSIBILI

Reversible knives

Wendeschneidplatten

Cuchillas reversibles

Сменные твердосплавные ножи

HW Z=4

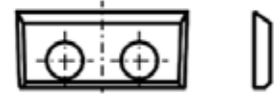
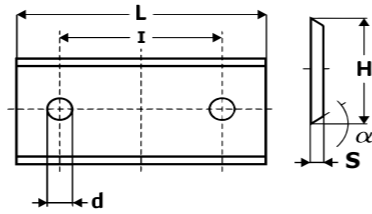

L	H	S	I	F.01-4.T	SM.01-4.HMT	M.30-2.DT	F.10/40-3.DT
mm	mm	mm	mm				
16.0	7.0	1.5	7.0	03.04.16715			

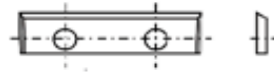

L	H	S	I	F.01-4.T	SM.01-4.HMT	M.30-2.DT	F.10/40-3.DT
mm	mm	mm	mm				
23.0	7.0	1.5	14.0	03.04.23715			
28.0	7.0	1.5	14.0	03.04.28715	03.20.28715		



L	H	S	I	F.01-4.T	SM.01-4.HMT	M.30-2.DT	F.10/40-3.DT
mm	mm	mm	mm				
16.0	7.0	1.5	7.0	03.04.16715-1			

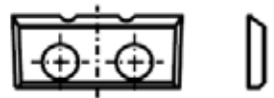

L	H	S	I	F.01-4.T	SM.01-4.HMT	M.30-2.DT	F.10/40-3.DT
mm	mm	mm	mm				
16.0	7.0	1.5	7.0	03.04.16715-2			
23.0	7.0	1.5	14.0	03.04.23715-2			

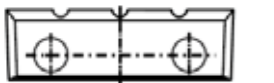

L	H	S	I	F.01-4.T	SM.01-4.HMT	M.30-2.DT	F.10/40-3.DT
mm	mm	mm	mm				
23.0	7.0	1.5	14.0	03.04.23715-3			

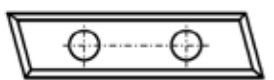

L	H	S	I	F.01-4.T	SM.01-4.HMT	M.30-2.DT	F.10/40-3.DT
mm	mm	mm	mm				
31.5	9.0	1.5	14.0	03.04.315915			

COLTELLI REVERSIBILI QUADRATI

Square knives

Quadratische Wendeschneidplatten

Cuchillas reversibles cuadradas

Сменные квадратные ножи

HW

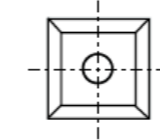
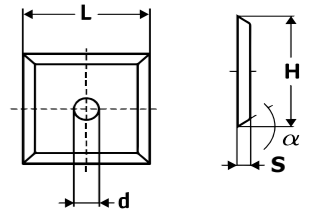

L	H	S	d	F.01-4.T	SM.01-4.HMT	M.30-2.DT	F.10/40-3.DT
mm	mm	mm	mm				
9.0	9.0	1.5	4	35°	04.40.9915		
10.5	10.5	1.5	4	35°	04.40.10510515		
12.0	12.0	1.5	4	35°	04.40.1215	04.20.1215	04.90.1215
13.0	13.0	2.5	4	35°	04.40.131325		
17.0	17.0	2.0	3	35°	04.40.172-F3		04.80.172-F3
17.0	17.0	2.0	4	35°	04.40.172		04.80.172
19.0	19.0	2.0	4	35°	04.40.19192		04.0.172

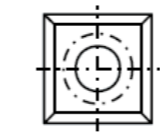

L	H	S	d	F.01-4.T	SM.01-4.HMT	M.30-2.DT	F.10/40-3.DT
mm	mm	mm	mm				
13.0	13.0	2.5	30°			04.80.1325/30	
13.6	13.6	2.0	30°			04.80.1362/30	
13.6	13.6	2.0	45°			04.80.1362/45	
14.0	14.0	1.2	30°			04.80.1412/30	
14.0	14.0	1.7	22°			04.80.1417/22	
14.0	14.0	1.7	30°			04.80.147/30	
14.0	14.0	2.0	30°	04.40.142/30	04.20.142/30	04.80.142/30	04.90.142/30

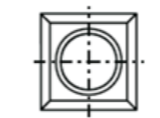

For Holz-Her system

L	H	S	d	M.30-2.DT
mm	mm	mm	mm	
14.0	14.0	1.2	30°	04.80.1412-HHS

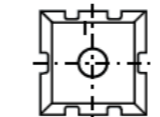

L	H	S	d	M.30-2.DT
mm	mm	mm	mm	
15.0	15.0	2.0		04.80.152

COLTELLI REVERSIBILI QUADRATI PER TESTE PIALLA

Square knives for planer heads

Quadratische Wendeschneidplatten für Hobelköpfe

Cuchillas reversibles cuadradas para portacuchillas de cepillo

Сменные квадратные ножи для строгальных головок

HW

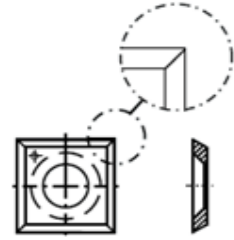
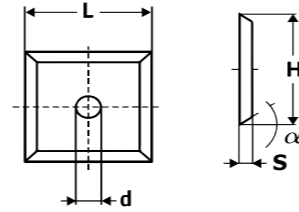

L	H	S					
mm	mm	mm		F.01-4.T	SM.01-4.HMT	M.30-2.DT	F.10/40-3.DT
10.5	10.5	1.5	35°				
14.0	14.0	2.0	30°	07.40.142/30D		07.80.142/30D	07.90.142/30D
14.0	14.0	2.0	37°			07.80.142/37D	07.90.142/37D
14.3	14.3	2.5	35°				07.90.14325/35D
14.6	14.6	2.5	30°				07.90.14625/30D
15.0	15.0	2.5	30°				07.90.1525/30D
15.0	15.0	2.5	37°				07.90.1525/37D

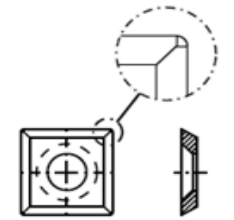

L	H	S					
mm	mm	mm		F.01-4.T	SM.01-4.HMT	M.30-2.DT	F.10/40-3.DT
14.0	14.0	2.0	30°			07.80.142/30R	07.90.142/30R
14.6	14.6	2.5	30°				07.90.14625/30R
15.0	15.0	2.5	30°				07.90.1525/30R
15.0	15.0	2.5	37°				07.90.1525/37R

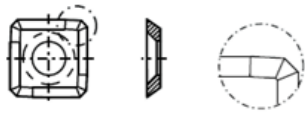

For Ledinek system - left/right

L	H	S					
mm	mm	mm		F.01-4.T	SM.01-4.HMT	M.30-2.DT	F.10/40-3.DT
14.3	14.3	2.5	35°				07.90.14325-LS/L
14.3	14.3	2.5	35°				07.90.14325-LS/R

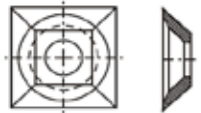

L	H	S					
mm	mm	mm		F.01-4.T	SM.01-4.HMT	M.30-2.DT	F.10/40-3.DT
21.0	21.0	5.5	40°	04.90.2155			07.90.2155

COLTELLI REVERSIBILI QUADRATI PER TESTE PIALLA

Square knives for planer heads

Quadratische Wendeschneidplatten für Hobelköpfe

Cuchillas reversibles cuadradas para portacuchillas de cepillo

Сменные квадратные ножи для строгальных головок

HW

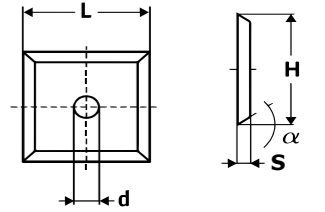

L	H	S						
mm	mm	mm	R		F.01-4.T	SM.01-4.HMT	M.30-2.DT	F.10/40-3.DT
15.0	15.0	2.5	150	30°				08.90.1525RR150
15.0	15.0	2.5	115	30°				08.90.1525RR115



L	H	S						
mm	mm	mm	R		F.01-4.T	SM.01-4.HMT	M.30-2.DT	F.10/40-3.DT
14.0	14.0	2.0	150	30°				08.90.142RR150
14.6	14.6	2.5	150	30°				08.90.14625RR150
15.0	15.0	2.5	50	30°				08.90.1525RR50
15.0	15.0	2.5	180	30°				08.90.1525RR180
15.0	15.0	2.5	200	30°				08.90.1525RR200

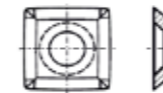

L	H	S						
mm	mm	mm	R		F.01-4.T	SM.01-4.HMT	M.30-2.DT	F.10/40-3.DT
15.0	15.0	2.5	170	40				08.90.1525R170

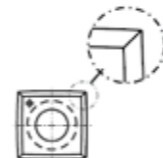

L	H	S						
mm	mm	mm	R		F.01-4.T	SM.01-4.HMT	M.30-2.DT	F.10/40-3.DT
15.0	15.0	2.5	150	30°				08.90.1525R150
15.0	15.0	2.5	100	30°				08.90.1525R100

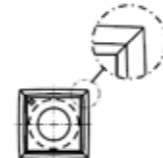

L	H	S						
mm	mm	mm	R		F.01-4.T	SM.01-4.HMT	M.30-2.DT	F.10/40-3.DT
14.0	14.0	2.0	150	30°				08.90.142R150
14.6	14.6	2.5	150	30°				08.90.14625R150
15.0	15.0	2.5	50	30°				08.90.1525R50

COLTELLI REVERSIBILI SPECIALI

Special reversible knives

Spezial-wendeschneidplatten

Cuchillas reversible especial

Сменные твердосплавные специальные ножи

HW

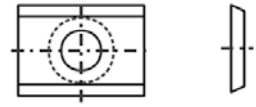
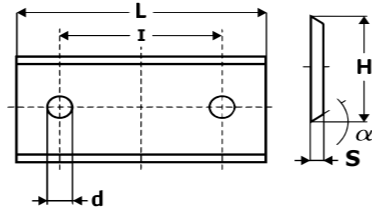

L	H	S	I	F-01-4.T	SM.01-4.MT	M.30-2.DT	F.10/40.3.DT
mm	mm	mm	mm				
20.0	14.3	2.5		05.40.2014325-A			

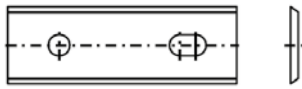

L	H	S	I	F-01-4.T	SM.01-4.MT	M.30-2.DT	F.10/40.3.DT
mm	mm	mm	mm				
44.5	15.0	1.5	25.0	05.40.4451515-B			

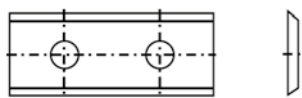

L	H	S	I	F-01-4.T	SM.01-4.MT	M.30-2.DT	F.10/40.3.DT
mm	mm	mm	mm				
30.0	12.0	1.5	16.0	05.40.301215-C			



L	H	S	I	F-01-4.T	SM.01-4.MT	M.30-2.DT	F.10/40.3.DT
mm	mm	mm	mm				
24.0	12.0	1.5		0540.241215-D			

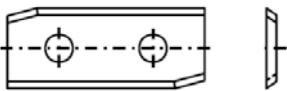

L	H	S	I	F-01-4.T	SM.01-4.MT	M.30-2.DT	F.10/40.3.DT
mm	mm	mm	mm				
30.0	12.0	1.5	14.0	05.40.301215-E			
50.0	12.0	1.5	26.0	05.40.501215-E			

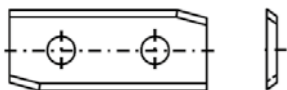

L	H	S	I	F-01-4.T	SM.01-4.MT	M.30-2.DT	F.10/40.3.DT
mm	mm	mm	mm				
30.0	12.0	1.5	14.0	05.40.301215-F			
50.0	12.0	1.5	26.0	05.40.501215-F			

COLTELLI REVERSIBILI SPECIALI

Special reversible knives

Spezial-wendeschneidplatten

Cuchillas reversible especial

Сменные твердосплавные специальные ножи

HW

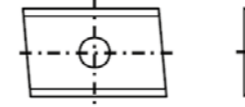
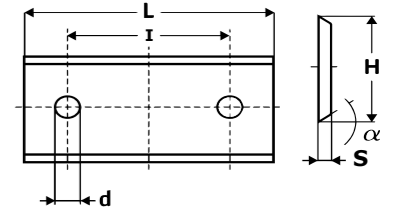

L	H	S	I	F-01-4.T	SM.01-4.MT	M.30-2.DT	F.10/40.3.DT
mm	mm	mm	mm				
20.0	12.0	1.5		05.40.201215-G			

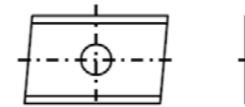

L	H	S	I	F-01-4.T	SM.01-4.MT	M.30-2.DT	F.10/40.3.DT
mm	mm	mm	mm				
20.0	12.0	1.5		05.40.201215-H			

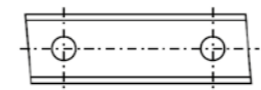

L	H	S	I	Codice	F-01-4.T	SM.01-4.MT	M.30-2.DT	F.10/40.3.DT
mm	mm	mm	mm					
30.0	12.0		14.0	05.40.301215-I				
40.0	12.0		26.0	05.40.401215-I				
50.0	12.0	1.5	26.0	05.40.501215-I				

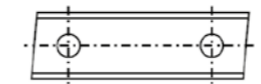

L	H	S	I	Codice	F-01-4.T	SM.01-4.MT	M.30-2.DT	F.10/40.3.DT
mm	mm	mm	mm					
30.0	12.0		14.0	05.40.301215-L				
40.0	12.0		26.0	05.40.401215-L				
50.0	12.0	1.5	26.0	05.40.501215-L				

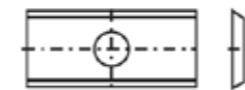

L	H	S	I	Codice	F-01-4.T	SM.01-4.MT	M.30-2.DT	F.10/40.3.DT
mm	mm	mm	mm					
20.0	9.0	1.5		05.40.20915-M				



L	H	S	I	Codice	F-01-4.T	SM.01-4.MT	M.30-2.DT	F.10/40.3.DT
mm	mm	mm	mm					
24.0	9.0	1.5	14.0	05.40.24915-N				
30.0	9.0	1.5	14.0	05.40.30915-N				
40.0	9.0	1.5	26.0	05.40.40915-N				

RASANTI, COLTELLI PER SCANALATURA

Spurs, grooving knives

Vorschneider, Nuter

Incisores, cuchillas para ranura

Твердосплавные ножи для формирования пазов

HM



L	H	S					
mm	mm	mm		F.01-4.T	SM.01-4.HMT	M.30-2.DT	F.10/40-3.DT
18.0	18.0	1.95				09.80.1818195	
18.0	18.0	2.45				09.80.1818245	
18.0	18.0	2.95				09.80.1818295	
18.0	18.0	3.70				09.80.1818370	



L	H	S	I				
mm	mm	mm	mm	F.01-4.T	SM.01-4.MT	M.30-2.DT	F.10/40.3.DT
22.9	19.8	2.5	30°			09.80.22919825	
22.0	19.0	2.0	30°			09.80.22192	
22.0	22.0	2.0	30°			09.80.22222	



L	H	S	I				
mm	mm	mm	mm	F.01-4.T	SM.01-4.MT	M.30-2.DT	F.10/40.3.DT
14.0	28.0	2.0	30°			09.80.14282	
16.0	16.0	3.0	32°			09.80.16163	

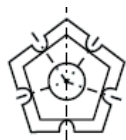

L	H	S	I				
mm	mm	mm	mm	F.01-4.T	SM.01-4.MT	M.30-2.DT	F.10/40.3.DT
18.5		3.25	30°				09.90.185325



L	H	S	I				
mm	mm	mm	mm	F.01-4.T	SM.01-4.MT	M.30-2.DT	F.10/40.3.DT
18.9	7.9	4.0				09.80.189794	



L	H	S	I				
mm	mm	mm	mm	F.01-4.T	SM.01-4.MT	M.30-2.DT	F.10/40.3.DT
18.0	5.7	3.5		09.40.185735			